

# Laser Barcode Scanner User Manual

## Introduction

This is a easily use manual for laser barcode scanner , if you need the more details about how to use ,please download from our official website or get the manual from distributors.

## Installation

### ☐ keyboard wedge cable installation

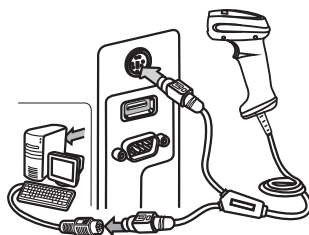

keyboard wedge cable installation

### ☐ RS-232 Cable installation

1. Turn off the power supply
2. Put the DB9 connector connected to the device port.
3. If the device (The 9<sup>th</sup> pin of serial) can not working, please connect the 5V power supply.
4. Turn on the power .if the buzzer and LED light release the signal, so the device is working normal.

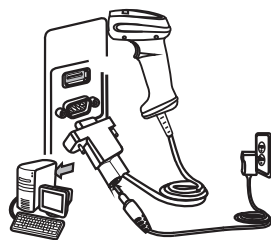

RS-232 Cable installation

### ☐ USB Cable installation (put the cable insert the USB serial directly, The Computer will detection and identification automatically

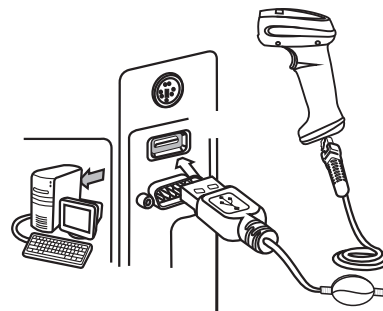

### ☐ Accessories: Bracket installation

1. Use the bracket connector connect to the main body of bracket.
2. Main body of bracket.
3. Philip's screw, Dimensions: M6\*10MM
4. Base Support
5. Direct wedged in the base of bracket when the head of bracket and main body connection well.

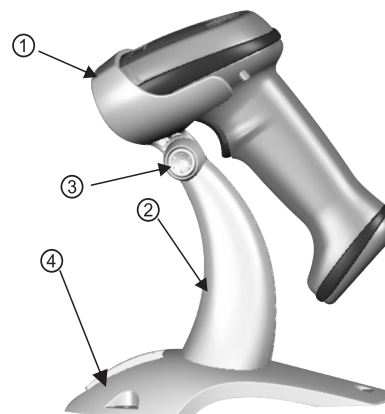

## DATA Interface Selection



USB-HID



PS2-Keyboard



USB-COM



COM-RS232

## Scanning Type



Automatic successive scanning



Automatic flashing

## Buzzer



Sound OFF



Sound ON

## Barcode Display Type



Display barcode type after barcode



UN-Display type after barcode



Factory Default



Version V5.8

## Keyboard Model

### Language Selection



USA



German



France

### Keyboard Caps Lock Control



None



Capitalize



Lower case

## Serial Model

### Baud Rate



4800



9600



19200



38400



57600



115200

### Prefix&Suffix Setting



AddPre



AddSuff



Hide Before  
Character



Hide After Character

## Special Code ON



CODE11



CODE 39



FULL ASCII



CODE 93



CODE 128



CODE 128ISBT



CODEBAR



Enable Interleaved  
2 of 5



Industrial 2 of 5



Matrix 2 of 5



CHINA POST CODE



MSI CODE



UPC-A



UPC-E



EAN-13



EAN-8

### Suffix & Skip Setting



CR



LF



CR&LF



Tab



Space



None

### Wireless Setting



RF Model



Delete ADD



Setting DeviceADD



01



02



03



04



Paired ADD



Inventory Mode



Up lodaing New Data



Up lodaing All Data



Up loading Statistic Data



Clear