

2D Barcode Scanner

Quick Start Guide



- Contents:
- Barcode Scanner
 - Quick Start Guide
 - USB Cable
 - USB Adapter

No. :75050144

1 Scanner overview

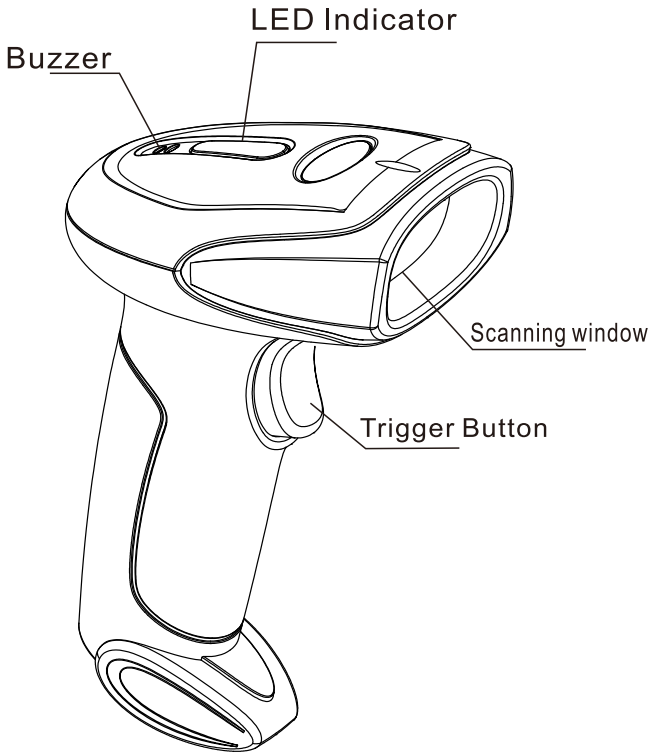

Barcode scanner

NOTE: Part of the product is different from the figure

2 Adaptor installation and pairing

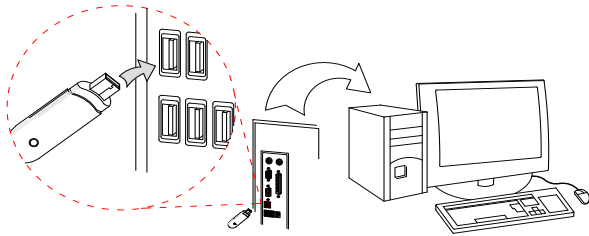

Method :

First step: Insert the adaptor as above picture. the blue light of the adaptor will continue (on not able to pair when blue light flashing.) .
Second step: After insert the adaptor , it must be scan the below bar code within 20s.



Pair in one step

3 Scanning method and distance

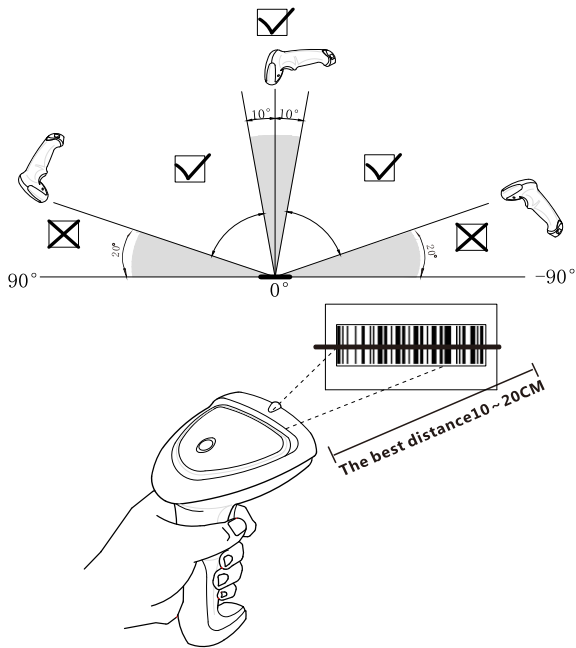

NOTE: LED beam should be full covered on the bar code

Wireless settings Setting Step

- 1 Scan the barcode of "Enter setting"
Enter setting (@SET)
- 2 Scan function bar code
Restore factory defaults
- 3 Scan "Exit and Save" Bar code
Exit and save (@END)

Note: All functions must be in accordance with the settings for The above process or scan the bar code setting function is invalid.

1 Transmitter(Scanner)

Working mode

Following working mode can be set directly.



*Real-time mode



Inventory mode



Cache mode

Note:

Real time mode: Scan and tranmit,data will automatically lost if upload failed.
Cache mode: Same as real time mode if connection normal. Scan bar codes will be automatically restore if connection failed. Will upload one by one if connection return as normal.
Inventory Mode: Scanning bar codes will be restored without upload. Will upload once sacan "Upload data" barcode. Will clear once scan "Clear data" . Will check sum once scan" Data sum"

2 Inventory mode setting

Following working mode can be set directly.



Upload data



Data sum



Clear Data

Upload data: Bar code data will transmit to terminal once scan this bar code.

Date sum: Scan "Data sum" bar code to check the scanner restore data sum.

Clear data: Scan "Clear data" and clear all the restore data in scanner

3 Switch operation mode



Turn on auto switch to wire mode.



Turn off auto switch to wire mode.

Turn on auto switch to wire mode: After the data receiver notify the scanner. Scanner can transmit the data via USB cable.

Turn off auto switch to wire mode: No able to transmit data via USB cable when the wire mode turn off. USB can only for battery charging.

4 Sleep time setting

The sleep time means the time between the last operation move and auto turn off the scanner. User able to scan the corresponding bar code of the sleep time which is needed to accomplish the sleep time setting.

Sleep time setting process:

Step1:Scan " SET "bar code , enter setting.
Step2:Scan the corresponding sleep time bar code to accomplish the setting.
Step3:Scan " END "bar code , finish setting.

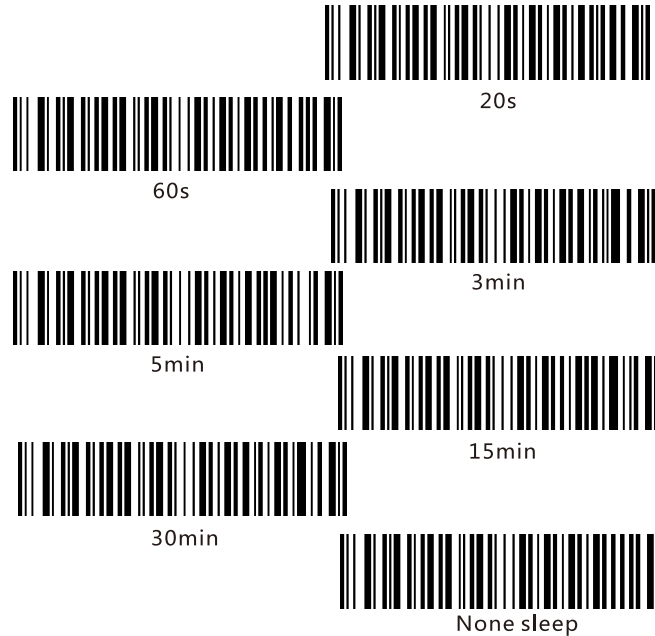

Barcode settings



Enable Setting

Note:Scan the “Enable setting” code, then you can change the scanner’s parameters by scanning one or more setting codes



Disable Setting

Note: Scan the “Disable setting” code, the function of changing the scanner’s parameters will close

① Restore factory default



Restore factory defaults

Note: 1. Restore factory default will change interface Mode.Refer to Interface Mode Selection for setting interface
2. With "*" in bold means factory default parameter.

② Auto trigger



Disable auto trigger



*** Enable auto trigger**

③ Illumination



normal



Disable



Continuous on

④ AIM



normal



Continuous on



Disable

Light

LED Status	Description
Scanner	
Red light turn green	power on
Red light blinks	Pairing match
Green light blinks once	Upload successfully
Green light blinks twice	Upload failed
Green light on	Working normally
Red light on	Low battery
Blue light on	Charging normal
Green light on	Charging complete
Green light blinking	Pairing unsuccessful

Adapter	
Blue light on	Working normally
Blue light blinks twice	Successful pairing
Blue light blinking	Pairing match

Buzzer

Scanner beeper mode	Description
Four Beeps	Power on
Short three beeps	Pairing successfully
Short one beep	Scan and transmit successfully
Short three beeps	Data upload failed
Short one beep	Power off
Long short beep	Enter setting mode
Four Beeps	Power on
Short three beeps	Pairing successfully
Short one beep	Scan and transmit successfully
short three beeps	Data upload failed
short one beep	Power off
Long short beep	Enter Setting Mode



FQA:

Q1.After scanning data.the scanner have sound of "du du du" three times means the data not uploaded.
A1 : Pair again (Follow " adaptor install and pairing" process)

Q2.No data upload after scanning, but no warning tore.
A2 : Scan"Realtime mode"barcode(in the "operation mode"under "wireless transmit setting")

Q3.Scan bar code. the data which display in terminal is two more byte than the original bar code data.
A3 : Scan “ID hide” barcode (in the “user ID hide/display seting” under “wireless transmit setting”)

Q4.Press the button. no laser comes out of the scanner.
A4 : Low power. please charge the scanner.